

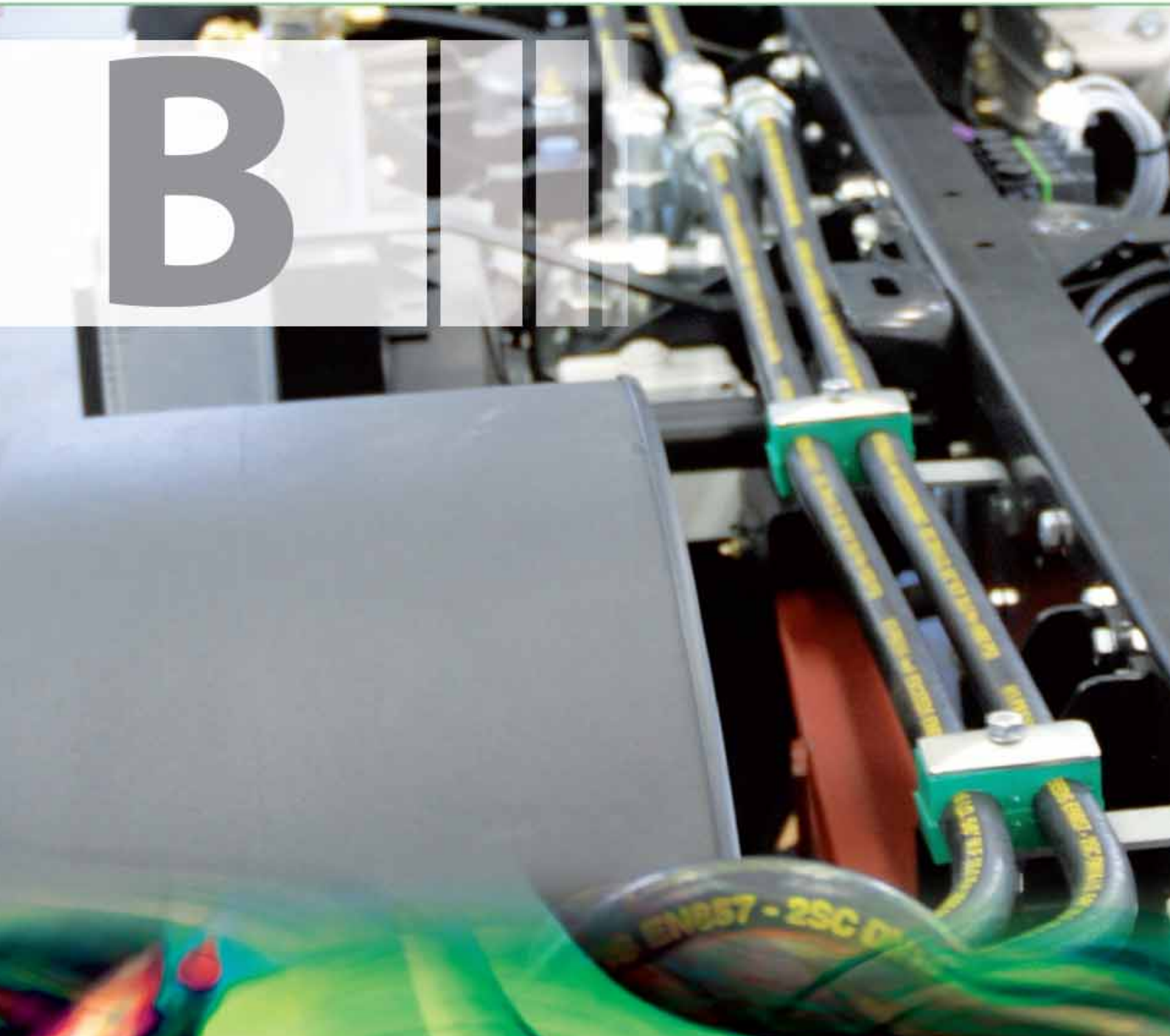

IMM.M.M.

Хомуты

В



В

IMM HyPress
IMM Group

Общие данные

General data

Всоответствии с требованиями DIN 3015, крепежные хомуты производятся из:

Manufactured to DIN 3015, the collars clamps are manufactured in:

- Полипропилен с ребристыми половинками (по заказу гладкими) - для стандартной, тяжелой и сдвоенной серий
Polypropylene with ribbed clamp halve (on request smooth) - For standard, heavy-duty and double series.
- Полиамид - (нейлон 6-6, обогащен 20% стекловолокном, самозатухающий) - для стандартной, тяжелой и сдвоенной версий
Polyamide - (Nylon 6-6 loaded with 20% of fi breglass, self-extinguishing VO) - For standard, heavy-duty and double series.
- Резина - для стандартной, тяжелой и сдвоенной серий
Rubber - For standard, heavy-duty and double series.
- Аллюминия для крепежа труб легкой или тяжелой серии.
Aluminium - for standard and heavy-duty series.

Прочие металлические компоненты крепежа производятся из:

The other metallic components of the clamps are manufactured in:

- Сталь FE 35 - плиты основания, верхние плиты; сборочные рейки.
Steel FE 35 - lower and upper plates; mounting rails.
- Сталь A6S - болты и шайбы.
Сталь A6S - болты и шайбы.

Под заказ мы можем изготовить все металлические части из нержавеющей стали 304 - 316 и 316L.

On request we can produce all metallic parts in stainless steel 304 - 316 and 316L.

Как заказать

How to Order

CS P 1 - 0064
SCS P 1 - 0064

P	Полипропилен / Polypropylene	<i>(стандартный вари</i>
M	Полиамид / Polyamide	<i>(под заказ)</i>
R	Резина / Rubber	<i>(под заказ)</i>
A	Аллюминий / Aluminium	<i>(под заказ)</i>

Хомуты / Clamps

Страница / Page	2	3	4-6
standard clamps	 <p>CSPX Стандартный вариант - полипропиленовые полускобы</p>	 <p>CPPX Стандартные полускобы с верхней плитой из полипропилена</p>	 <p>- Стандартные компоненты крепежа</p>
Страница / Page	7		8-10
double clamps	 <p>CDPX Двойные полипропиленовые скобы</p>		 <p>- Компоненты двойного крепежа</p>
Страница / Page	11-12		13-16
heavy clamps	 <p>CHPX Полипропиленовый крепеж тяжелой серии</p>		 <p>- Компоненты крепежа тяжелой серии</p>

Dimensions and general characteristics may be changed at any time without prior notice.

Data contained herein are for information purpose only, and it does not enlarge, amend or imply any warranty other than provided by us with the product
Any use of the product not in conformance with our instructions may be dangerous.

CSPX Стандартный вариант - полипропиленовые полускобы

Standard clamps in Polypropilene

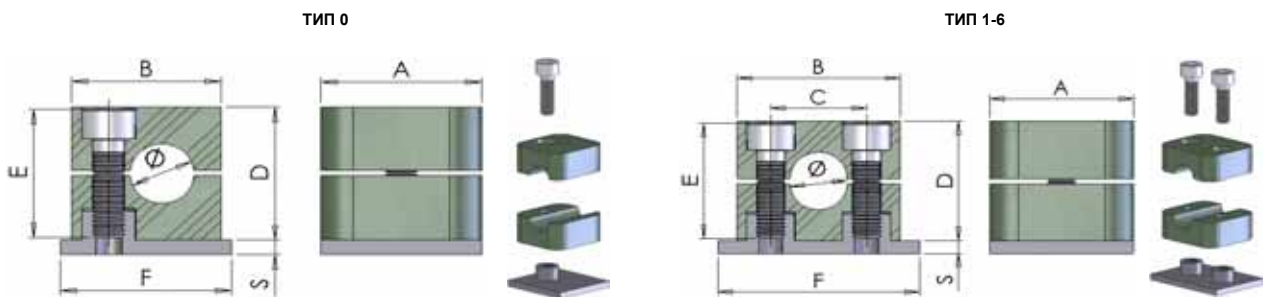

Codice Part number	Ø Tubo Ø Tube		Tipo Type	Dimensioni Dimension								
	Poll./Inch			A	B	C	D	F	S	E		
	mm	Gas		O.D.	X	mm						
CSP0-0060	6,0											
CSP0-0080	8,0		5/16"	0	30	28	-	27	32	3	M 6x20	
CSP0-0100	10,0	1/8"										
CSP0-0120	12,0											
CSP1-0060	6,0											
CSP1-0064	6,4		1/4"	1	30	34	20	27	42	3	M 6x20	
CSP1-0080	8,0		5/16"									
CSP1-0095	9,5		3/8"									
CSP1-0100	10,0	1/8"										
CSP1-0120	12,0											
CSP2-0127	12,7		1/2"									
CSP2-0135	13,5	1/4"										
CSP2-0140	14,0											
CSP2-0150	15,0											
CSP2-0160	16,0		5/8"	2	30	40	26	33	48	3	M 6x25	
CSP2-0172	17,2	3/8"										
CSP2-0180	18,0											
CSP2-0190	19,0		3/4"									
CSP3-0190	19,0		3/4"									
CSP3-0200	20,0											
CSP3-0213	21,3	1/2"										
CSP3-0220	22,0		7/8"	3	30	48	33	35	55	3	M 6x30	
CSP3-0250	25,0											
CSP3-0254	25,4		1"									
CSP4-0269	26,9	3/4"										
CSP4-0280	28,0			4	30	57	40	42	62	3	M 6x35	
CSP4-0300	30,0											
CSP4-0320	32,0		1.1/4"									
CSP5-0320	32,0		1.1/4"									
CSP5-0337	33,7	1"										
CSP5-0350	35,0											
CSP5-0380	38,0		1.1/2"	5	30	68	52	58	74	3	M 6x50	
CSP5-0400	40,0											
CSP5-0420	42,0											
CSP5-0424	42,4	1.1/4"										
CSP5-0450	45,0											
CSP6-0445	44,5		1.1/4"									
CSP6-0483	48,3	1.1/2"		6	30	86	66	66	88	3	M 6x60	
CSP6-0508	50,8		2"									

CPPX Стандартные полускобы с верхней плитой из полипропилена

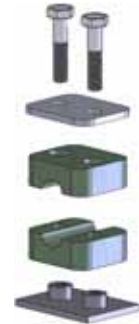
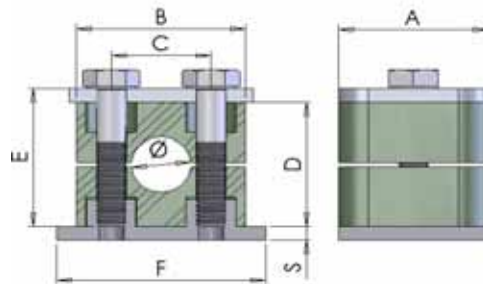

Standard clamps with upper plate in Polypropylene



Codice Part number	Ø Tubo Ø Tube			Tipo Type	Dimensioni Dimension						
	Poll./Inch		X		A	B	C	D	F	S	E
	mm	Gas			O.D.	mm					
CPP1-0060	6,0			1	30	34	20	27	42	3	M 6x30
CPP1-0064	6,4		1/4"								
CPP1-0080	8,0		5/16"								
CPP1-0095	9,5		3/8"								
CPP1-0100	10,0	1/8"									
CPP1-0120	12,0										
CPP2-0127	12,7		1/2"	2	30	40	26	33	48	3	M 6x35
CPP2-0135	13,5	1/4"									
CPP2-0140	14,0										
CPP2-0150	15,0										
CPP2-0160	16,0	5/8"									
CPP2-0172	17,2	3/8"									
CPP2-0180	18,0										
CPP2-0190	19,0		3/4"	3	30	48	33	35	55	3	M 6x40
CPP3-0190	19,0		3/4"								
CPP3-0200	20,0	1/2"									
CPP3-0213	21,3										
CPP3-0220	22,0	7/8"									
CPP3-0250	25,0										
CPP3-0254	25,4		1"	4	30	57	40	42	62	3	M 6x45
CPP4-0269	26,9	3/4"									
CPP4-0280	28,0										
CPP4-0300	30,0										
CPP4-0320	32,0		1.1/4"	5	30	68	52	58	74	3	M 6x60
CPP5-0520	32,0		1.1/4"								
CPP5-0337	33,7	1"									
CPP5-0350	35,0										
CPP5-0380	38,0		1.1/2"								
CPP5-0400	40,0										
CPP5-0420	42,0										
CPP5-0424	42,4	1.1/4"		6	30	86	66	66	88	3	M 6x70
CPP5-0450	45,0										
CPP6-0445	44,5	1.1/4"									
CPP6-0483	48,3	1.1/2"									
CPP6-0508	50,8		2"								

Стандартные компоненты крепежа

Standard clamps components

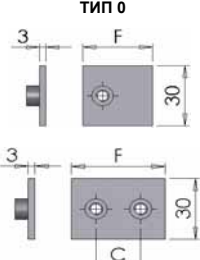
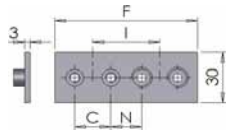
 semi-collare in polipropilene polypropilene clamp-half		 coppia collari in polipropilene polypropilene clamp body		ТИП 0  piastra inferiore lower plate (LPS...)			ТИП 1-6  piastra inferiore doppia double lower plate (LPDS...)				
code	price	code	price	F mm	C mm	F mm	C mm	N mm	I mm	n° collari clamps	
ТИПО 0				LPS0			LPDS0				
SCSP0-0060		CCSP0-0060									
SCSP0-0080		CCSP0-0080									
SCSP0-0100		CCSP0-0100		32	-	61	-	-	30	2	
SCSP0-0120		CCSP0-0120									
ТИПО 1				LPS1			LPDS1				
SCSP1-0060		CCSP1-0060									
SCSP1-0064		CCSP1-0064									
SCSP1-0080		CCSP1-0080									
SCSP1-0095		CCSP1-0095		42	20	81	20	20	40	2	
SCSP1-0100		CCSP1-0100									
SCSP1-0120		CCSP1-0120									
ТИПО 2				LPS2			LPDS2				
SCSP2-0127		CCSP2-0127									
SCSP2-0135		CCSP2-0135									
SCSP2-0140		CCSP2-0140									
SCSP2-0150		CCSP2-0150									
SCSP2-0160		CCSP2-0160		48	26	91	26	18	44	2	
SCSP2-0172		CCSP2-0172									
SCSP2-0180		CCSP2-0180									
SCSP2-0190		CCSP2-0190									
ТИПО 3				LPS3			LPDS3				
SCSP3-0190		CCSP3-0190									
SCSP3-0200		CCSP3-0200									
SCSP3-0213		CCSP3-0213									
SCSP3-0220		CCSP3-0220		55	33	106	33	19	52	2	
SCSP3-0250		CCSP3-0250									
SCSP3-0254		CCSP3-0254									
ТИПО 4				LPS4			LPDS4				
SCSP4-0269		CCSP4-0269									
SCSP4-0280		CCSP4-0280									
SCSP4-0300		CCSP4-0300		62	40	148	52	23	75	2	
SCSP4-0320		CCSP4-0320									
ТИПО 5				LPS5			LPDS5				
SCSP5-0320		CCSP5-0320									
SCSP5-0337		CCSP5-0337									
SCSP5-0350		CCSP5-0350									
SCSP5-0380		CCSP5-0380									
SCSP5-0400		CCSP5-0400		74	52	148	52	23	75	2	
SCSP5-0420		CCSP5-0420									
SCSP5-0424		CCSP5-0424									
SCSP5-0450		CCSP5-0450									
ТИПО 6				LPS6			LPDS6				
SCSP6-0445		CCSP6-0445									
SCSP6-0483		CCSP6-0483									
SCSP6-0508		CCSP6-0508		88	66	177	66	24	90	2	

Стандартные компоненты крепежа

Standard clamps components

		ТИП 0					ТИП 1-6							
		piastra inferiore multipla multiple lower plate					piastra superiore upper plate		vite T.C.E.I. T.C.E.I. screws		vite a testa esagonale hexagonal head screw		vite a testa esag. allungata high hexagonal head screw	
		(LPMS...)				n°	(UPS...)		(VTEIS...)		(VTES...)		(VTEAS...)	
		F	C	N	I	collari	F	C	M	E	M	E	M	E
		mm	mm	mm	mm	clamps	mm	mm	mm	mm	mm	mm	mm	mm
ТИП 0		LPMS0					UPS0		VTEIS0		VTES0		VTEAS0	
		306	-	-	30	10	28	-	M6	20	M6	30	M6	20
ТИП 1		LPMS1					UPS1		VTEIS1		VTES1		VTEAS1	
		404	20	20	40	10	37	20	M6	20	M6	30	M6	20
ТИП 2		LPMS2					UPS2		VTEIS2		VTES2		VTEAS2	
		447	26	18	44	10	43	26	M6	25	M6	35	M6	25
ТИП 3		LPMS3					UPS3		VTEIS3		VTES3		VTEAS3	
		525	33	19	52	10	50	33	M6	30	M6	40	M6	30
ТИП 4		LPMS4					UPS4		VTEIS4		VTES4		VTEAS4	
		375	52	53	75	5	57	40	M6	35	M6	45	M6	35
ТИП 5		LPMS5					UPS5		VTEIS5		VTES5		VTEAS5	
		375	52	23	75	5	69	52	M6	50	M6	60	M6	50
ТИП 6		LPMS6					UPS6		VTEIS6		VTES6		VTEAS6	
		447	66	24	90	5	83	66	M6	60	M6	70	M6	60

Стандартные компоненты крепежа

Standard clamps components

	piastra sup. di sicurezza security upper plate	binari portanti (spessore 2 mm.) rail (thickness 2 mm)	dado fissaggio binari Rail Nut	rondella flat washer
	(SUPS...)	(BINS...)	(FIXS...)	(RONS...)
	F mm	b mm	M	d mm
ТИП 0	SUPS0 28	-		
ТИП 1	SUPS1 34	20		
ТИП 2	SUPS2 41	BINS1 26	28	11
ТИП 3	SUPS3 47	BINS2 33	FIXS1 M6	RONS1 M6
ТИП 4	SUPS4 57	BINS3 40		
ТИП 5	SUPS5 67	28	30	
ТИП 6	SUPS6 82	66		

CDPX Двойные полипропиленовые скобы

Double Polypropylene Clamps

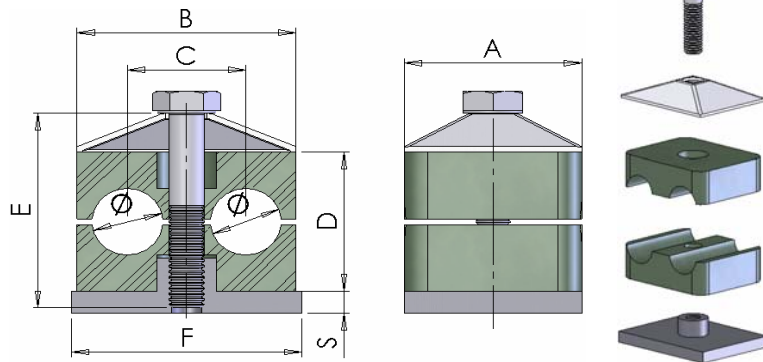

Codice Part number	Ø Tubo Ø Tube		Tipo Type	Dimensioni Dimension							
	Poll./Inch			A	B	C	D	F	S	E	
	mm	Gas		O.D.	X	mm					
CDP1-0060	6,0			1	30	37	20	25	37	3	M 6x35
CDP1-0064	6,4		1/4"								
CDP1-0080	8,0		5/16"								
CDP1-0095	9,5		3/8"								
CDP1-0100	10,0	1/8"									
CDP1-0120	12,0										
CDP2-0127	12,7		1/2"	2	30	53	29	26	55	5	M 6x35
CDP2-0135	13,5		1/4"								
CDP2-0140	14,0										
CDP2-0150	15,0		5/8"								
CDP2-0160	16,0										
CDP2-0172	17,2	3/8"									
CDP2-0180	18,0										
CDP3-0190	19,0		3/4"	3	30	67	36	37	70	5	M 6x45
CDP3-0200	20,0		1/2"								
CDP3-0213	21,3	1/2"									
CDP3-0220	22,0		7/8"								
CDP3-0250	25,0										
CDP3-0254	25,4		1"								
CDP4-0269	26,9	3/4"		4	30	82	45	42	85	5	M 6x50
CDP4-0280	28,0										
CDP4-0300	30,0										
CDP5-0320	32,0		1.1/4"	5	30	106	56	54	110	5	M 6x60
CDP5-0337	33,7		1"								
CDP5-0350	35,0										
CDP5-0380	38,0		1.1/2"								
CDP5-0400	40,0										
CDP5-0420	42,0										
CDP5-0424	42,4	1.1/4"									

Компоненты двойного крепежа

Double clamps components

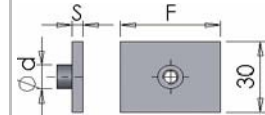
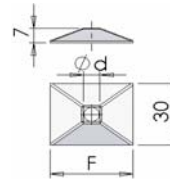
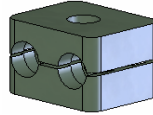

semi-collare in polipropilene polypropilene clamp-half		coppia collari in polipropilene polypropilene clamp body		piastra superiore upper plate		piastra inferiore lower plate		
code	price	code	price	(UPD...)		(LPD...)		
				F mm	Ød mm	F mm	Ød mm	S mm
ТИП 1	SCDP1-0060	CCDP1-0060		UPD1		LPD1		
	SCDP1-0064	CCDP1-0064						
	SCDP1-0080	CCDP1-0080						
	SCDP1-0095	CCDP1-0095		35	7	37	12	3
	SCDP1-0100	CCDP1-0100						
	SCDP1-0120	CCDP1-0120						
ТИП 2	SCDP2-0127	CCDP2-0127		UPD2		LPD2		
	SCDP2-0135	CCDP2-0135						
	SCDP2-0140	CCDP2-0140						
	SCDP2-0150	CCDP2-0150		52	9	55	14	5
	SCDP2-0160	CCDP2-0160						
	SCDP2-0172	CCDP2-0172						
	SCDP2-0180	CCDP2-0180						
ТИП 3	SCDP3-0190	CCDP3-0190		UPD3		LPD3		
	SCDP3-0200	CCDP3-0200						
	SCDP3-0213	CCDP3-0213						
	SCDP3-0220	CCDP3-0220		66	9	70	14	5
	SCDP3-0250	CCDP3-0250						
ТИП 4	SCDP4-0269	CCDP4-0269		UPD4		LPD4		
	SCDP4-0280	CCDP4-0280						
	SCDP4-0300	CCDP4-0300		81	9	85	14	5
ТИП 5	SCDP5-0320	CCDP5-0320		UPD5		LPD5		
	SCDP5-0337	CCDP5-0337						
	SCDP5-0350	CCDP5-0350						
	SCDP5-0380	CCDP5-0380		105	9	110	14	5
	SCDP5-0400	CCDP5-0400						
	SCDP5-0420	CCDP5-0420						
	SCDP5-0424	CCDP5-0424						

Компоненты двойного крепежа

Double clamps components

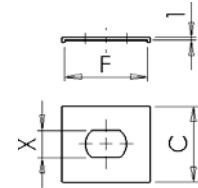
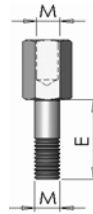
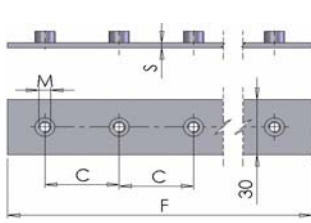

	piastra inferiore multipla multiple lower plate					vite a testa esagonale hexagonal head screw		vite a testa esag. allungata high hexagonal head screw		piastra sup. di sicurezza security upper plate		
	(LPMD...)				n° collari clamps	(VTED...)		(VTEAD...)		(SUPD...)		
	F mm	C mm	S mm	M		M	E mm	M	E mm	F mm	C mm	X mm
ТИП 1	LPMD1					VTED1		VTEAD1		SUPD1		
	200	40	3	M6	5	M6	35	M6	20	30	30	11
ТИП 2	LPMD2					VTED2		VTEAD2		SUPD2		
	290	58	5	M8	5	M8	35	M8	20			
ТИП 3	LPMD3					VTED3		VTEAD3				
	360	72	5	M8	5	M8	45	M8	29			
ТИП 4	LPMD4					VTED4		VTEAD4				
	450	90	5	M8	5	M8	50	M8	34			
ТИП 5	LPMD5					VTED5		VTEAD5				
	560	112	5	M8	5	M8	60	M8	47			

Компоненты двойного крепежа

Double clamps components

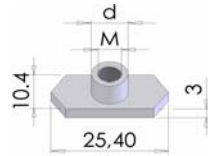
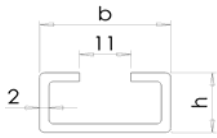

binari portanti (spessore 2 mm.) rail (thickness 2 mm)			dado fissaggio binari Rail Nut	
(BIND...)			(FIXD...)	
b mm	h mm		M	d mm
BIND1			FIXD1	
			M6	12
28	11		FIXD2	
BIND2				
28	14			
BIND3				
28	30			

CHPX Полипропиленовый крепеж тяжелой серии

Heavy duty Polypropylene Clamps

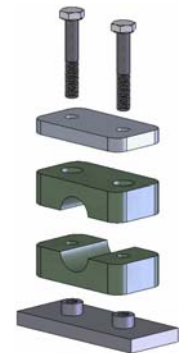
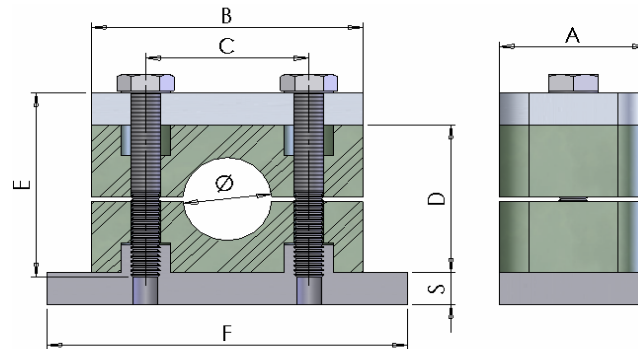

Codice Part number	Ø Tubo Ø Tube		Tipo Type	Dimensioni Dimension							
	Poll./Inch			A	B	C	D	F	S	E	
	mm	Gas O.D.		mm							
CHP1-0060	6,0										
CHP1-0064	6,4	1/4"									
CHP1-0080	8,0	5/16"									
CHP1-0095	9,5	3/8"									
CHP1-0100	10,0	1/8"									
CHP1-0120	12,0										
CHP1-0127	12,7	1/2"	1	30	55	33	32	73	8	M 6x35	
CHP1-0135	13,5	1/4"									
CHP1-0140	14,0										
CHP1-0150	15,0										
CHP1-0160	16,0	5/8"									
CHP1-0172	17,2	3/8"									
CHP1-0180	18,0										
CHP2-0190	19,0	3/4"									
CHP2-0200	20,0										
CHP2-0213	21,3	1/2"									
CHP2-0220	22,0	7/8"									
CHP2-0250	25,0		2	30	70	45	48	85	8	M 6x35	
CHP2-0254	25,4	1"									
CHP2-0269	26,9	3/4"									
CHP2-0280	28,0										
CHP2-0300	30,0										
CHP3-0300	30,0										
CHP3-0320	32,0	1.1/4"									
CHP3-0337	33,7	1"									
CHP3-0350	35,0		3	30	85	60	60	10	8	M 6x45	
CHP3-0380	38,0	1.1/2"									
CHP3-0400	40,0										
CHP3-0420	42,0										
CHP3-0424	42,4	1.1/4"									
CHP4-0380	38,0	1.1/2"									
CHP4-0420	42,0		4	45	120	90	90	140	10	M 12x100	
CHP4-0424	42,4	1.1/4"									
CHP4-0445	44,5	1.3/4"									
CHP4-0483	48,3	1.1/2"									

CHPX Полипропиленовый крепеж тяжелой серии

Heavy duty Polypropylene Clamps

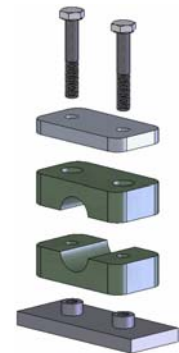
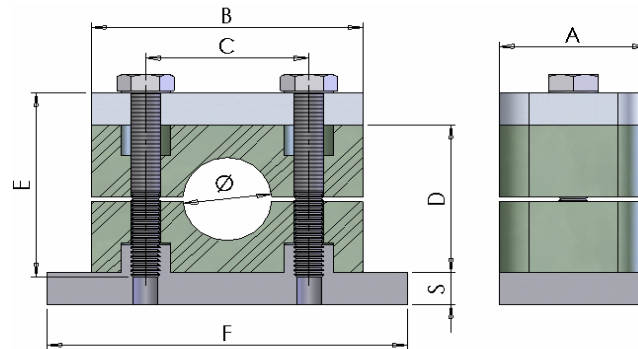

Codice Part number	Ø Tubo Ø Tube		Tipo Type	Dimensioni Dimension								
	Poll./Inch			A	B	C	D	F	S	E		
	mm	Gas		O.D.	X	mm						
CHP4-0500	50,0											
CHP4-0508	50,8		2"									
CHP4-0550	55,0											
CHP4-0570	57,0		2.1/4"	4	45	120	90	90	140	10	M 12x100	
CHP4-0603	60,3	2"										
CHP4-0635	63,5		2.1/2"									
CHP4-0650	65,0											
CHP4-0700	70,0		2.3/4"									
CHP5-0650	65,0											
CHP5-0700	70,0											
CHP5-0750	75,0											
CHP5-0761	76,1	2.1/2"	3"	5	60	152	122	120	180	10	M 16x130	
CHP5-0800	80,0											
CHP5-0825	82,5		3.1/4"									
CHP5-0889	88,9	3"	3.1/2"									
CHP6-0899	89,9	3"	3.1/2"									
CHP6-1000	100,0											
CHP6-1016	101,6	3.1/2"	4"									
CHP6-1080	108,0		4.1/4"	6	80	205	168	170	225	15	M 20x190	
CHP6-1143	114,3	4"	4.1/2"									
CHP6-1270	127,0	4.1/2"	5"									
CHP6-1330	133,0		5.1/2"									
CHP7-1330	133,0		5.1/4"									
CHP7-1397	139,7	5"	5.1/2"									
CHP7-1524	152,4	5.1/2"	6"	7	90	250	205	200	270	15	M 24x220	
CHP7-1650	165,0		6.1/2"									
CHP7-1683	168,3	6"										
CHP8-1683	168,3	6"										
CHP8-1778	177,8		7"									
CHP8-1937	193,7		7.5/8"	8	120	320	265	270	340	25	M 30x300	
CHP8-2160	216,0		8.1/2"									
CHP8-2191	219,1	8"										

Компоненты крепежа тяжелой серии

Heavy clamps components

semi-collare in polipropilene		coppia collari in polipropilene		piastra inferiore				piastra superiore			
polypropilene clamp-half		polypropilene clamp body		lower plate				upper plate			
code	price	code	price	(LPH...)				(UPH...)			
				A mm	F mm	C mm	S mm	A mm	F mm	C mm	S mm
ТИП 1				LPH1				UPH1			
SCHP1-0060		CCHP1-0060		30	75	33	8	30	55	33	8
SCHP1-0064		CCHP1-0064									
SCHP1-0080		CCHP1-0080									
SCHP1-0095		CCHP1-0095									
SCHP1-0100		CCHP1-0100									
SCHP1-0120		CCHP1-0120									
SCHP1-0127		CCHP1-0127									
SCHP1-0135		CCHP1-0135									
SCHP1-0140		CCHP1-0140									
SCHP1-0150		CCHP1-0150									
SCHP1-0160		CCHP1-0160									
SCHP1-0172		CCHP1-0172									
SCHP1-0180		CCHP1-0180									
ТИП 2				LPH2				UPH2			
SCHP2-0190		CCHP2-0190		30	87	45	8	30	70	45	8
SCHP2-0200		CCHP2-0200									
SCHP2-0213		CCHP2-0213									
SCHP2-0220		CCHP2-0220									
SCHP2-0250		CCHP2-0250									
SCHP2-0254		CCHP2-0254									
SCHP2-0269		CCHP2-0269									
SCHP2-0280		CCHP2-0280									
SCHP2-0300		CCHP2-0300									
SCHP2-0300		CCHP2-0300									
ТИП 3				LPH3				UPH3			
SCHP3-0300		CCHP3-0300		30	102	60	8	30	85	60	8
SCHP3-0320		CCHP3-0320									
SCHP3-0337		CCHP3-0337									
SCHP3-0350		CCHP3-0350									
SCHP3-0380		CCHP3-0380									
SCHP3-0400		CCHP3-0400									
SCHP3-0420		CCHP3-0420									
SCHP3-0424		CCHP3-0424									
ТИП 4				LPH4				UPH4			
SCHP4-0380		CCHP4-0380		45	140	90	10	45	120	90	10
SCHP4-0420		CCHP4-0420									
SCHP4-0424		CCHP4-0424									
SCHP4-0445		CCHP4-0445									
SCHP4-0483		CCHP4-0483									

Компоненты крепежа тяжелой серии

Heavy clamps components

semi-collare in polipropilene		coppia collari in polipropilene		piastra inferiore				piastra superiore			
polypropilene clamp-half		polypropilene clamp body		lower plate				upper plate			
code	price	code	price	(LPH...)				(UPH...)			
				A	F	C	S	A	F	C	S
				mm	mm	mm	mm	mm	mm	mm	mm
				LPH4				UPH4			
ТИП 4											
SCHP4-0500		CCHP4-0500									
SCHP4-0508		CCHP4-0508									
SCHP4-0550		CCHP4-0550									
SCHP4-0570		CCHP4-0570									
SCHP4-0603		CCHP4-0603		45	140	90	10	45	120	90	10
SCHP4-0635		CCHP4-0635									
SCHP4-0650		CCHP4-0650									
SCHP4-0700		CCHP4-0700									
				LPH5				UPH5			
ТИП 5											
SCHP5-0650		CCHP5-0650									
SCHP5-0700		CCHP5-0700									
SCHP5-0750		CCHP5-0750									
SCHP5-0761		CCHP5-0761		60	180	122	10	60	152	122	10
SCHP5-0800		CCHP5-0800									
SCHP5-0825		CCHP5-0825									
SCHP5-0889		CCHP5-0889									
				LPH6				UPH6			
ТИП 6											
SCHP6-0899		CCHP6-0899									
SCHP6-1000		CCHP6-1000									
SCHP6-1016		CCHP6-1016									
SCHP6-1080		CCHP6-1080		80	225	168	15	80	205	168	15
SCHP6-1143		CCHP6-1143									
SCHP6-1270		CCHP6-1270									
SCHP6-1330		CCHP6-1330									
				LPH7				UPH7			
ТИП 7											
SCHP7-1330		CCHP7-1330									
SCHP7-1397		CCHP7-1397									
SCHP7-1524		CCHP7-1524									
SCHP7-1650		CCHP7-1650		90	270	205	15	90	250	205	15
SCHP7-1683		CCHP7-1683									
				LPH8				UPH8			
ТИП 8											
SCHP8-1683		CCHP8-1683									
SCHP8-1778		CCHP8-1778									
SCHP8-1937		CCHP8-1937									
SCHP8-2160		CCHP8-2160		120	340	265	25	120	320	265	25
SCHP8-2191		CCHP8-2191									

Компоненты крепежа тяжелой серии

Heavy clamps components

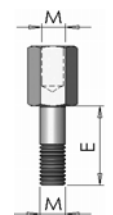
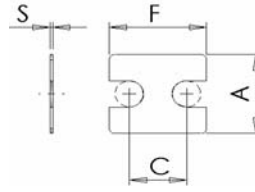
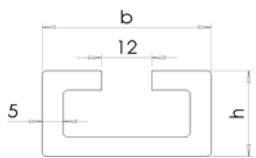
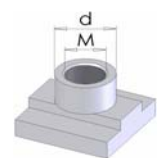
					
	vite a testa esagonale	vite a testa esag. allungata	piastra superiore di sicurezza	binari portanti (spessore 5 mm.)	dado fissaggio binari
	hexagonal head screw	high hexagonal head screw	security upper plate	rail (thickness 5 mm)	rail nut
	(VTEH...)	(VTEAH...)	(SUPH...)	(BINH...)	(FIXH...)
	M E mm	M E mm	A F C S mm mm mm mm	b h mm mm	M d mm
ТИП 1	VTEH1 M10 45	VTEAH1 M10 26	SUPH1 30 55 33 8		
ТИП 2	VTEH2 M10 60	VTEAH2 M10 41	SUPH2 30 70 45 8	BINH1 40 22	FIXH1 M10 18
ТИП 3	VTEH3 M10 70	VTEAH3 M10 52	SUPH3 30 85 60 8		

Компоненты крепежа тяжелой серии

Heavy clamps components

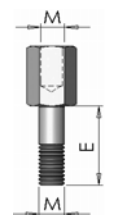
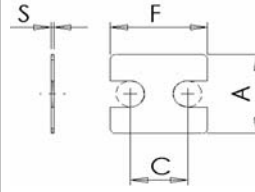
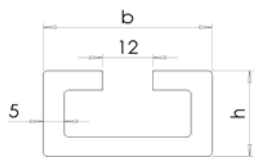
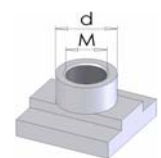
					
	vite a testa esagonale	vite a testa esag. allungata	piastra superiore di sicurezza	binari portanti (spessore 5 mm.)	dado fissaggio binari
	hexagonal head screw	high hexagonal head screw	security upper plate	rail (thickness 5 mm)	rail nut
	(VTEH...)	(VTEAH...)	(SUPH...)	(BINH...)	(FIXH...)
	M E mm	M E mm	A F C S mm mm mm mm	b h mm mm	M d mm
	VTEH4	VTEAH4	SUPH4		
ТИП 4	M12 100	M12 83	45 120 90 10	BINH1	FIXH2
	VTEH5	VTEAH5	SUPH5	40 22	M12 20
ТИП 5	M16 130	M16 110	60 152 122 10		
	VTEH6				
ТИП 6	M20 190	- -	- - - -	- -	- -
	VTEH7				
ТИП 7	M24 220	- -	- - - -	- -	- -
	VTEH8				
ТИП 8	M30 300	- -	- - - -	- -	- -