

A pressure gauge is visible in the top left corner, showing a scale from 0 to 2000 bar. The background features a vibrant, abstract design with blue and green wavy patterns and a rainbow-like light effect on the right side.

IMM.M.M.



Q

Фитинг для рукава PTFE

P
Q

The logo for IMM HyPress, featuring the letters 'IMM' in a stylized, bold font with a green-to-blue gradient, followed by 'HyPress' in a black, italicized sans-serif font. Below it, 'IMM Group' is written in a smaller, black sans-serif font.

IMM HyPress
IMM Group

Фиттинг рукавов PTFE / Fittings for PTFE hose

Страница / Page	2	2	3	3	5	
Ghiere Ferrule			GAS BSP			
	TTP1 Per Tubo 'T' For 'T' hose	T00TC Per Tubo 'TC' For 'TC' hose		T051 BSP straight 60° cone	T151 BSP 90° 60° cone	T350 BSP Male
Страница / Page	4		4		5	
Metric Metrico			Jic		Male BSPT	
	T100 Metric straight 60° cone			T901 Jic straight 37° Flare		T360 BSPT Male Maschio BSPT
Страница / Page	6		6		7	
Male NPT			Occhio Banjo		Ermeto Standpipe	
	T370 NPT Male Maschio NPT			T140 Banjo Occhio		T550 Ermeto - Standpipe DIN 3901
Страница / Page	7	8	8		9	
Flange					Female Reusable	
	TPFO Porta Flangia	TPFR Porta Flangia rivestita PTFE	TFPG Flangia Piana Girevole			TR51 BSP Female Reusable

Dimensions and general characteristics may be changed at any time without prior notice.

Data contained herein are for information purpose only, and it does not enlarge, amend or imply any warranty other than provided by us with the product
Any use of the product not in conformance with our instructions may be dangerous.

0TP1 Обжимная муфта

Swaged Ferrule

для рукава / for hose:

TP1 - TM1 - T2 - THP

Материал (std): Бронза - UNI 5705-65

Material (std): Brass - UNI 5705-65

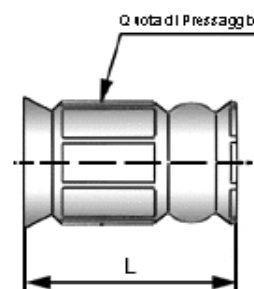

part number	hose I.D.		Dimensions	
	mm	inch	L	Диаметр обжима**
0TP1-03	5	3/16"	16,5	10,8
0TP1-04	6,5	1/4"	18	12,9
0TP1-05	8	5/16"	20	14,4
0TP1-06	9,5	3/8"	20	15,7
0TP1-07	10,5	13/32"	20	16,7
0TP1-08	13	1/2"	23,5	19,0
0TP1-10	16	5/8"	22	22,6
0TP1-12	19	3/4"	29	26,3
0TP1-14	22	7/8"	28	29,3
0TP1-16	25	1"	29	32,6
0TP1-18	28,5	1.1/8"	30,5	36,9
0TP1-20	32	1.1/4"	38	43,0
0TP1-24	38	1.1/2"	38	49,2
0TP1-50	50	2"	53	65,5

** - Допуск: $\pm 0,5\%$ диаметра обжима

00TC Обжимная муфта

Swaged Ferrule

для рукава / for hose:

TC

Материал (std): Бронза - UNI 5705-65

Material (std): Brass - UNI 5705-65

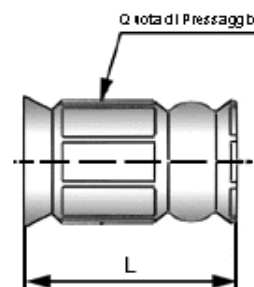

part number	hose I.D.		Dimensions	
	mm	inch	L	Диаметр обжима**
00TC-04	6,9	1/4"	26	10,8
00TC-06	9,5	3/8"	20	12,9
00TC-08	13	1/2"	21	14,4
00TC-10	16	5/8"	22	15,7
00TC-12	19	3/4"	28	16,7
00TC-16	25	1"	29	19,0
00TC-20	32	1.1/4"	38	22,6
00TC-24	38	1.1/2"	38	26,3
00TC-50	51	2"	53	29,3
*** 00TC-51	51	2"	53	32,6

** - Допуск: $\pm 0,5\%$ диаметра обжима

*** - Используйте исключительно детали покрытые P.T.F.E

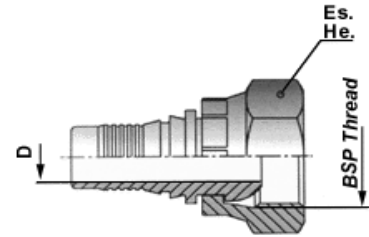
T051 Накидная гайка BSP 60°
BSP Female 60° cone

Материал (std): ниппель : Бронза - UNI 5705-65 / Гайка: сталь - UNI 5105

Material (std): insert: Brass - UNI 5705-65 / Nut: steel - UNI 5105

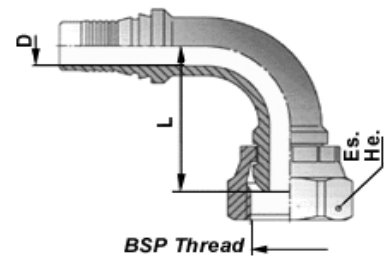
part number	hose I.D.		Dimensions			
	mm	inch	Thread	D	He	
T051-03-02	5	3/16"	1/8"	3,5	14	
T051-04-04	6,5	1/4"	1/4"	4,5	19	
T051-05-06	8	5/16"	3/8"	5,5	22	
T051-06-06	9,5	3/8"	3/8"	7,0	22	
T051-06-08	9,5	3/8"	1/2"	7,0	27	
T051-07-08	10,5	13/32"	1/2"	8,0	27	
T051-08-08	13	1/2"	1/2"	10,0	27	
T051-10-12	16	5/8"	3/4"	12,5	32	
T051-12-12	19	3/4"	3/4"	15,0	32	
T051-12-16	19	3/4"	1"	15,0	38	
T051-14-16	22	7/8"	1"	18,0	38	
T051-16-16	25	1"	1"	20,0	38	
T051-18-20	28,5	1.1/8"	1.1/4"	24,0	50	
T051-20-20	32	1.1/4"	1.1/4"	27,0	50	
T051-24-24	38	1.1/2"	1.1/2"	33,0	55	
T051-32-32	50	2"	2"	44,0	65	

T151 90° Накидная гайка BSP 60°
BSP 90° Swept elbow 60° cone

Материал (std): ниппель : Бронза - UNI 5705-65 / Гайка: сталь - UNI 5105

Material (std): insert: Brass - UNI 5705-65 / Nut: steel - UNI 5105

part number	hose I.D.		Dimensions			
	mm	inch	Thread	D	He	
T151-03-02	5	3/16"	1/8"	3,5	14	
T151-04-04	6,5	1/4"	1/4"	4,5	19	
T151-05-06	8	5/16"	3/8"	5,5	22	
T151-06-06	9,5	3/8"	3/8"	7,0	22	
T151-08-08	13	1/2"	1/2"	10,0	27	
T151-12-12	19	3/4"	3/4"	15,0	32	
T151-16-16	25	1"	1"	19,0	38	

T100 **Ниппель метрика 60°**

Metric Female 60° cone

Материал (std): ниппель : Бронза - UNI 5705-65 / Гайка: сталь - UNI 5105

Material (std): insert: Brass - UNI 5705-65 / Nut: steel - UNI 5105

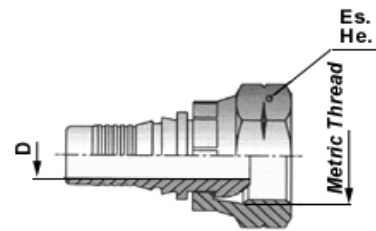

part number	hose I.D.		Dimensions			
	mm	inch	Thread	D	He	
T100-03-10	5	3/16"	10 x 1	3,5	14	
T100-04-12	5	1/4"	12 x 1	3,5	19	
T100-05-14	6,5	1/4"	14 x 1,5	4,5	19	
T100-06-16	8	5/16"	16 x 1,5	5,5	22	
T100-06-20	13	1/2"	20 x 1,5	10,0	24	
T100-07-22	13	1/2"	22 x 1,5	10,0	27	

T901 **Ниппель JIC 74°**

JIC Female 74° cone

Материал (std): ниппель : Бронза - UNI 5705-65 / Гайка: сталь - UNI 5105

Material (std): insert: Brass - UNI 5705-65 / Nut: steel - UNI 5105

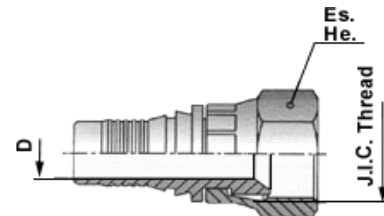

part number	hose I.D.		Dimensions			
	mm	inch	Thread	D	He	
T901-03-04	5	3/16"	7/16" - 20	3,5	15	
T901-04-05	6,5	1/4"	1/2" - 20	4,5	17	
T901-05-06	8	5/16"	9/16" - 18	5,5	19	
T901-05-05	8	5/16"	1/2" - 20	5,5	19	
T901-06-06	9,5	3/8"	9/16" - 18	7,0	19	
T901-07-08	10,5	13/32"	3/4" - 16	8,0	24	
T901-07-10	10,5	13/32"	7/8" - 14	10,0	27	
T901-08-08	13	1/2"	3/4" - 16	10,0	24	
T901-10-12	16	5/8"	1 1/16" - 12	12,5	32	

T350 Штуцер BSP конус 60°

BSP Male Parallel 60° cone

Материал (std): Бронза - UNI 5705-65

Material (std): Brass - UNI 5705-65

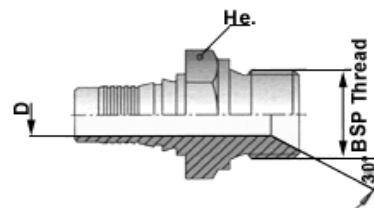

part number	hose I.D.		Dimensions			
	mm	inch	Thread	D	He	
T350-03-02	5	3/16"	1/8"	3,5	12	
T350-04-04	6,5	1/4"	1/4"	4,5	19	
T350-05-06	8	5/16"	3/8"	5,5	17	
T350-06-06	9,5	3/8"	3/8"	7,0	22	
T350-06-08	9,5	3/8"	1/2"	7,0	27	
T350-07-08	10,5	13/32"	1/2"	8,0	27	
T350-08-08	13	1/2"	1/2"	10,0	27	
T350-10-12	16	5/8"	3/4"	12,5	27	
T350-12-12	19	3/4"	3/4"	15,0	32	
T350-14-16	22	7/8"	1"	18,0	36	
T350-16-16	25	1"	1"	20,0	41	
T350-18-20	28,5	1 1/8"	1 1/4"	24,0	46	

T360 Штуцер BSPT конус 60°

BSP Taper Male 60° cone

Материал (std): Бронза - UNI 5705-65

Material (std): Brass - UNI 5705-65

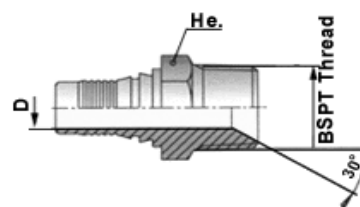

part number	hose I.D.		Dimensions			
	mm	inch	Thread	D	He	
T360-03-02	5	3/16"	1/8"	3,5	12	
T360-04-04	6,5	1/4"	1/4"	4,5	15	
T360-05-06	8	5/16"	3/8"	5,5	18	
T360-06-06	9,5	3/8"	3/8"	7,0	18	
T360-08-08	13	1/2"	1/2"	10,0	22	
T360-16-16	25	1"	1"	20,0	36	
T360-18-20	29	1 1/8"	1 1/4"	24,0	46	
T360-20-20	32	1 1/4"	1 1/4"	27,0	46	
T360-24-24	38	1 1/2"	1 1/2"	32,0	50	
T360-32-32	51	2"	2"	44,5	65	

T370 Штуцер NPTF конус 60°

NPTF Male 60° cone

Материал (std): Бронза - UNI 5705-65

Material (std): Brass - UNI 5705-65

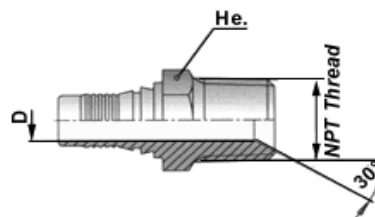

part number	hose I.D.		Dimensions			
	mm	inch	Thread	D	He	
T370-03-02	5	3/16"	1/8"	3,5	12	
T370-04-04	6,5	1/4"	1/4"	4,5	15	
T370-05-06	8	5/16"	3/8"	5,5	18	
T370-06-06	9,5	3/8"	3/8"	7,0	18	
T370-07-08	10,5	13/32"	1/2"	8,0	22	
T370-08-08	13	1/2"	1/2"	10,0	22	
T370-10-12	16	5/8"	3/4"	12,5	27	
T370-12-12	19	3/4"	3/4"	16,0	27	
T370-16-16	25	1"	1"	20,0	36	
T370-18-20	29	1 1/8"	1 1/4"	24,0	46	
T370-20-20	32	1 1/4"	1 1/4"	27,0	46	
T370-24-24	38	1 1/2"	1 1/2"	32,0	50	
T370-32-32	51	2"	2"	44,5	65	

T140 Банджо

Banjo

Материал (std): Бронза - UNI 5705-65

Material (std): Brass - UNI 5705-65

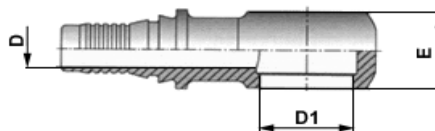

part number	hose I.D.		Dimensions			
	mm	inch	D1	D	E	
T140-03-10	5	3/16"	10,1	3,5	10	
T140-04-10	6,5	1/4"	10,1	4,5	10	
T140-04-12	6,5	1/4"	12,1	4,5	12	
T140-05-06	8	5/16"	16,7(3/8")	5,5	12	
T140-06-12	9,5	3/8"	12,1	7,0	15	
T140-06-04	9,5	3/8"	13,2(1/4")	7,0	15	
T140-06-14	9,5	3/8"	14,2	7,0	15	
T140-06-16	9,5	3/8"	16,2	7,0	15	
T140-08-08	13	1/2"	21(1/2")	10,0	22	
T140-12-12	19	3/4"	27	15,0	30	

T550 Трубка прессуемая метрическая

Metric Standpipe

Материал (std): Бронза - UNI 5705-65

Material (std): Brass - UNI 5705-65

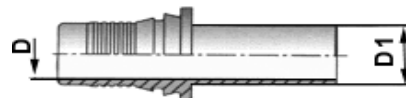

part number	hose I.D.		Dimensions		
	mm	inch	D1	D	
T550-03-06	5	3/16"	6	3,5	
T550-03-08	5	3/16"	8	3,5	
T550-04-06	6,5	1/4"	6	4,5	
T550-04-08	6,5	1/4"	8	4,5	
T550-04-10	6,5	1/4"	10	4,5	
T550-04-12	6,5	1/4"	12	4,5	
T550-05-10	8	5/16"	10	5,5	
T550-05-12	8	5/16"	12	5,5	
T550-06-12	9,5	3/8"	12	7,0	
T550-06-14	9,5	3/8"	14	7,0	
T550-08-12	13	1/2"	12	10,0	
T550-08-15	13	1/2"	15	10,0	
T550-08-16	13	1/2"	16	10,0	
T550-10-18	16	5/8"	18	12,5	
T550-10-20	16	5/8"	20	12,5	
T550-12-22	19	3/4"	22	15,0	
T550-12-25	19	3/4"	25	15,0	
T550-16-28	25	1"	28	20,0	
T550-16-30	25	1"	30	20,0	

TFLO Фланцевый коннектор

Flanged joint

Материал (std): Бронза - UNI 5705-65

Material (std): Brass - UNI 5705-65

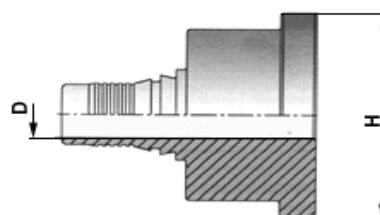

part number	hose I.D.		Dimensions		
	mm	inch	H	D	
TFLO-08-43	13	1/2"	43	10	
TFLO-12-45	19	3/4"	45	15	
TFLO-16-45	25	1"	45	20	
TFLO-20-60	32	1 1/4"	60	27	
TFLO-24-80	38	1 1/2"	80	32	
TFLO-32-80	50	2"	80	45	

TPFR Фланец, PTFE уплотнение

P.T.F.E. Lined flanged joint

Материал (std): Бронза - UNI 5705-65

Material (std): Brass - UNI 5705-65

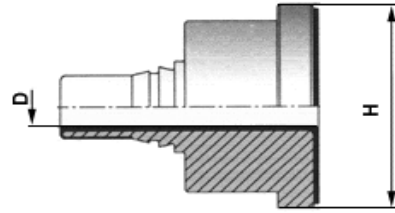

part number	hose I.D.		Dimensions		
	mm	inch	H	D	
TPFR-08-43	13	1/2"	43	8	
TPFR-12-45	19	3/4"	45	13	
TPFR-16-45	25	1"	45	18	
TPFR-20-60	32	1 1/4"	60	24	
TPFR-24-80	38	1 1/2"	80	29	
TPFR-32-80	50	2"	80	39	

TFFPG Вращающийся фланец

Swivel flange

According to: UNI 2278 PN 16

Материал (std): Бронза - UNI 5705-65

Material (std): Brass - UNI 5705-65

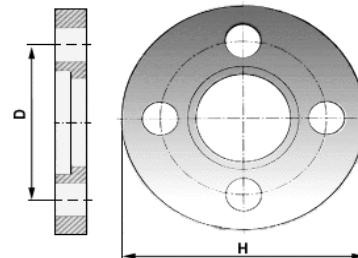

part number	DN		Dimensions			
	mm	inch	Ø ID Hole	D	H	
TFFPG-08	15	1/2"	14	65	95	
TFFPG-12	20	3/4"	14	75	105	
TFFPG-16	25	1"	14	85	115	
TFFPG-20	32	1 1/4"	18	100	140	
TFFPG-24	40	1 1/2"	18	110	150	
TFFPG-32	50	2"	18	125	165	
TFFPG-40	65	2 1/2"	18	145	185	
TFFPG-48	80	3"	18	160	200	
TFFPG-64	100	4"	18	180	220	

TR51 **Ниппель разборной, гайка BSP**

BSP straight female Reusable fitting

According to: **ISO 8434-2**

Материал (std): углеродистая сталь

Material (std): carbon steel

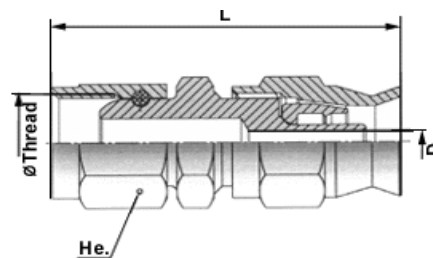

part number	hose I.D.		Dimensions			
	mm	inch	Thread	D	L	He
TR51-03-04	3/16"	5	1/4"	4,0	40,0	17
TR51-04-04	1/4"	6,5	1/4"	5,5	45,5	17
TR51-05-06	5/16"	8	3/8"	7,0	47,5	22
TR51-07-08	13/32"	10,5	1/2"	9,5	53,5	27
TR51-10-12	5/8"	16	3/4"	15,0	61,0	36
TR51-14-16	7/8"	22	1"	21,0	65,0	41

